

STEP 2 USE PIPE WRENCH TO REMOVE ELBOW WITH SPLIT UNION

STEP 1 USE PIPE AND CRESENT WRENCH TO SPLIT UNION

STEP 3 REMOVE (4) BOLTS, NUTS AND WASHERS USING 5/8" BOX OPEN END WRENCH, 11/16" SOCKET AND 12" EXTENSION. THESE FASTENERS WILL BE REUSED.

STEP 4 DISCONNECT ANY POWER SOURCE USE ELECTRICAL WIRE CUTTERS TO CUT PUMP POWER WIRES. LEAVE SUFFICIENT WIRE LENGTH TO RECONNECT TO NEW PUMP.

CAUTION: FAILURE TO DISCONNECT POWER SOURCE PRIOR TO CUTTING POWER WIRE MAY RESULT IN ELECTRICAL SHOCK, INJURY OR EXPLOSION.

STEP 5 REMOVE ENTIRE FUEL PUMP ASSEMBLY FROM STOWAGE COMPARTMENT

STEP 8 USE PIPE WRENCH TO REMOVE NIPPLE FROM PUMP

STEP 7 USE CRESENT WRENCH TO REMOVE PUMP FROM BUNG ADSPTOR

STEP 6 USE PIPE WRENCH TO REMOVE HOSE ASSEMBLY AND ELBOW FROM PUMP

STEP 9 REMOVE STRAIN RELIEF USING A CRESENT WRENCH. PLACE STRAIN RELIEF IN NEW PUMP

STEP 10 PUMP IS NOW COMPLETELY FREE. APPLY PIPE SEALANT TO PIPE THREADS. INSTALL NEW PUMP AND OTHER FITTINGS. RECONNECT POWER AND CONFIRM THERE ARE NO FUEL LEAKS. SEND OLD PUMP TO TRANSFER FLOW.,INC.

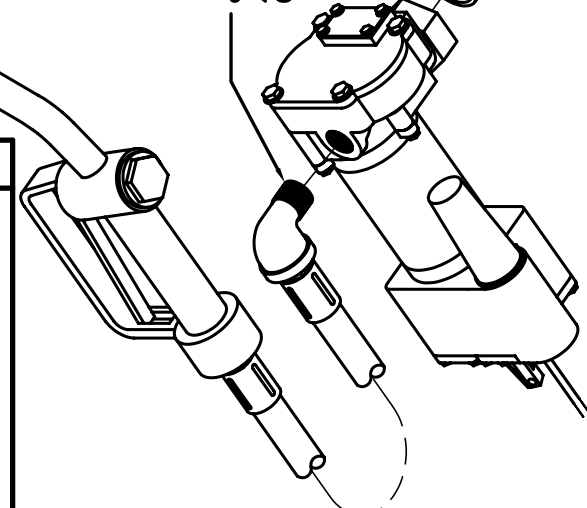
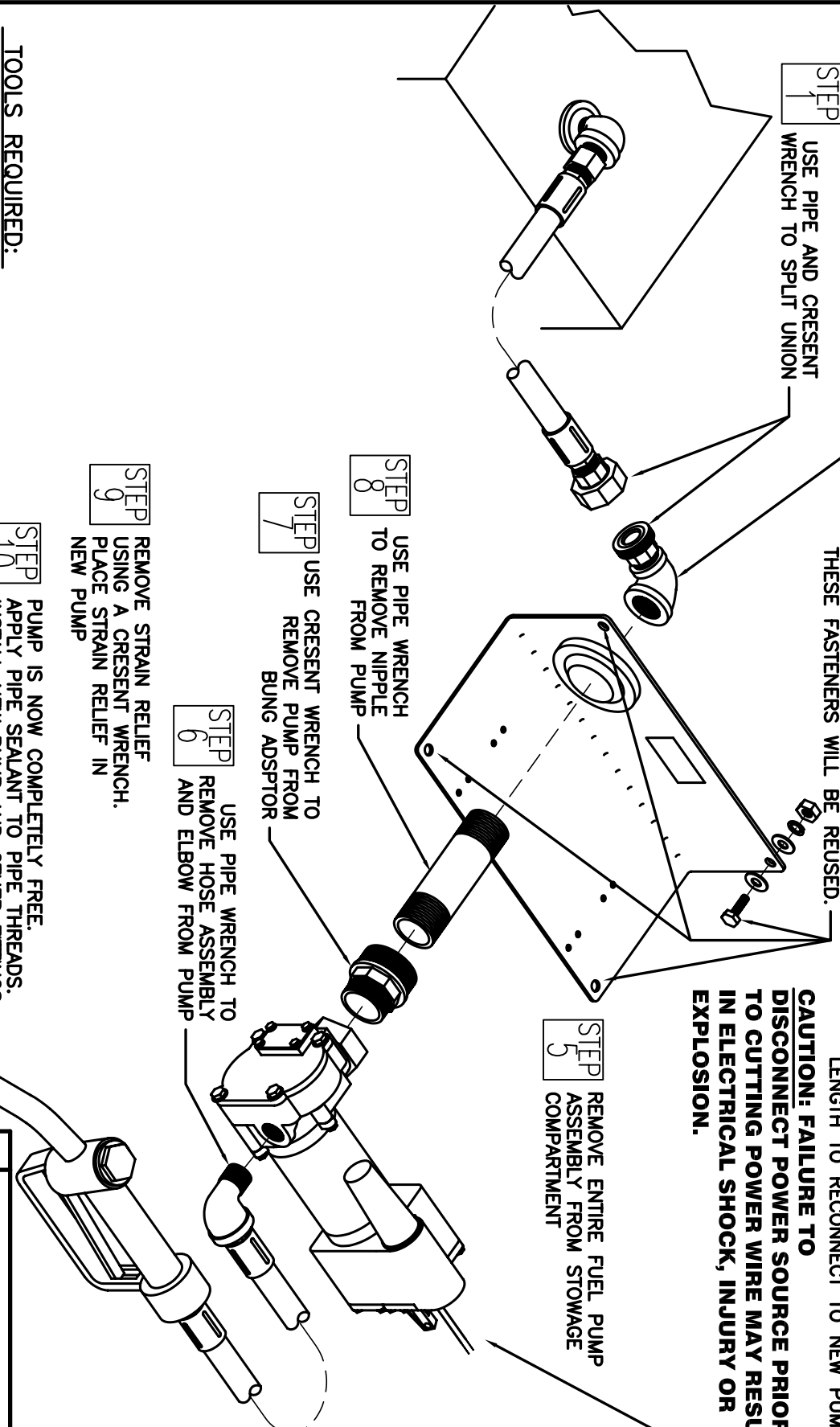

LTR	DESCRIPTION	BY	CHK	DATE	MRN
-----	-------------	----	-----	------	-----

		SCALE NO SCALE TOLERANCES UNLESS OTHERWISE NOTED: ANGLES ± 3° FRACTIONS ± 1/16" DECIMALS X ± .250 .XX ± .100 .XXX ± .025			
--	--	---	--	--	--

TITLE		DRAWING NO.			
PBL REFUELING PUMP REMOVAL INSTRUCTIONS		TSB 0001			

DRN BY	RAZ	CHK BY	DATE	APP BY	DATE	REV	A
DATE	11-15-05	DATE		DATE			

TOOLS REQUIRED:

- ELECTRICAL WIRE CUTTER
- ELECTRICAL WIRE CRIMPER
- 10-12" PIPE WRENCH
- 12" CRESENT WRENCH
- 5/8" SOCKET
- 11/16" SOCKET
- 5/8" BOX/OPEN END WRENCH
- 11/16" BOX/OPEN END WRENCH
- 12" EXTENSION
- RACHET